

A

AERIAL ELECTRICAL FITTINGS



ANCHORING BRACKET	ANCHORING CLAMP	FUSE SWITCH DISCONNECTOR	SUSPENSION CLAMP	PRE-INSULATED SLEEVE	PRE-INSULATED BIMETAL LUG	FIXING NAIL	ANCHORING CLAMP	FIXING STEEL BELT	INSULATED PIERCING CONNECTOR	INSULATED PIERCING CONNECTOR (LIGHTING)	INSULATED PIERCING CONNECTOR (TRANSFORMATION)



Low Voltage H.R.C Fuse

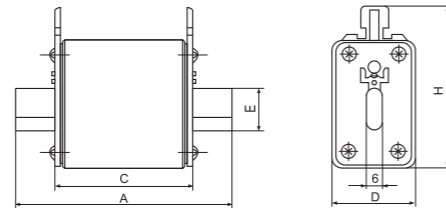

Basic Data

Model	Domestic and overseas similar products		Rated voltage (V)	Rated current (A)	Over all dimension(mm)				
	gG	aR			A	C	D	E	H
NH00C	NH00C	RS30C	500/690	4-100	78.5	49.5	21	15	52.5
NH00	NH00	RS31	500/690	10-160	78	50.5	30	15	60
NH0	NH0		500/690	6-160	125	67	30	15	60

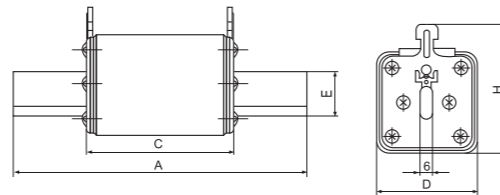

Basic Data

Model	Domestic and overseas similar products		Rated voltage (V)	Rated current (A)	Over all dimension(mm)				
	gG	aR			A	C	D	E	H
NH1	NH1	RS32	500/690	32-250	135	68	46	20	58.5
NH2	NH2	RS33	500/690	80-400	150	68	58	25	68.5
NH3	NH3	RS34	500/690	160-630	150	68	70	32	82

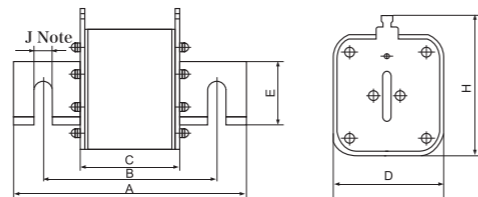

Basic Data

Model	Domestic and overseas similar products		Rated voltage (V)	Rated current (A)	Over all dimension(mm)					
	gG	aR			A	B	C	D	H	J
NH4	NH4	RS39	500/690	500-1250	200	150	90	97	113	16.5

Note: It is allowable to change the double-transverse type wiring hole one-transverse one-straight or double-straight type structure

Low Voltage H.R.C Fuse

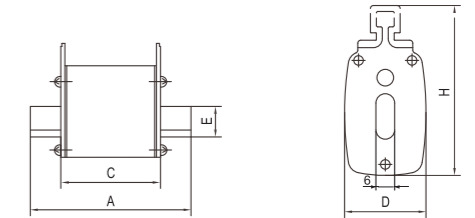

Basic Data

Model	Domestic and overseas similar products		Rated voltage (V)	Rated current (A)	Over all dimension(mm)				
	gG	aR			A	C	D	E	H
RO30A	NH00C		500/690	4-125	78	49	21	15	48
RT16-000	NT00CNH00C	RS30C	500/690	4-125	78	49	21	15	52
RT16-00	NT00NH00RT20-003NA	RS31	500/690	4-160	78	49	29	15	56
RT16-0	NT0NH0		500/690	4-160	125	68	29	15	56

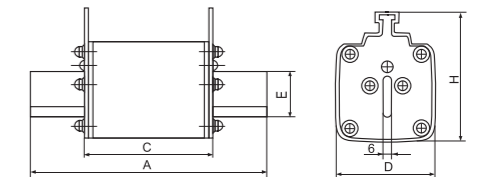

Basic Data

Model	Domestic and overseas similar products		Rated voltage (V)	Rated current (A)	Over all dimension(mm)				
	gG	aR			A	C	D	E	H
RT16-1	NT1NH1	RS32	500/690	32-250	135	68	48	20	60
RT16-2	NT2NH2	RS33	500/690	80-400	150	68	58	25	72
RT16-3	NT3NH3	RS34	500/690	160-630	150	68	68	32	84

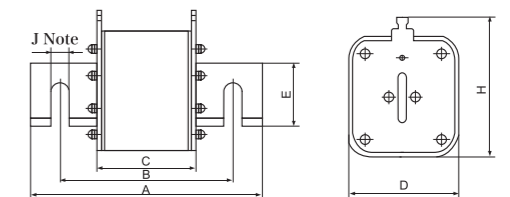

Basic Data

Model	Domestic and overseas similar products		Rated voltage (V)	Rated current (A)	Over all dimension(mm)					
	gG	aR			A	B	C	D	H	J
RT16-4	NT4RT17	RS39	500/690	500-1250	200	150	90	97	113	16.5

Note: It is allowable to change the double-transverse type wiring hole one-transverse one-straight or double-straight type structure

Low Voltage H.R.C Fuse

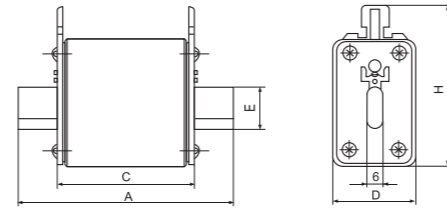

Basic Data

Model	Domesticand overseas similar products	Rated voltage (V)	Rated current (A)	Over all dimension(mm)				
				A	C	D	E	H
NH00S	NH00S	500/690	4-100	78.5	49.5	21	15	52.5
NH00S	NH00S	500/690	10-160	78	50.5	30	15	60
NH0S	NH0S	500/690	6-160	125	67	30	15	60

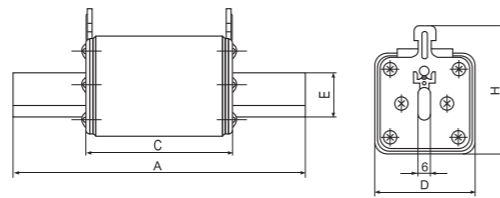

Basic Data

Model	Domesticand overseas similar products	Rated voltage (V)	Rated current (A)	Over all dimension(mm)				
				A	C	D	E	H
NH1S	NH1S	500/690	32-250	135	68	46	20	58
NH2S	NH2S	500/690	80-400	150	68	58	25	68
NH3S	NH3S	500/690	160-630	150	68	80	32	82

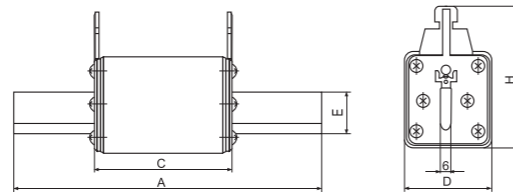

Basic Data

Model	Domesticand overseas similar products	Rated voltage (V)	Rated current (A)	Over all dimension(mm)				
				A	C	E	D	H
NH1C	NH1Csmallcapacity	500/690	16-160	136	68	15	30	67
NH2C	NH2Csmallcapacity	500/690	35-250	150	67	20	46	67
NH3C	NH3Csmallcapacity	500/690	200-400	151	67	25	58.5	81.5

Low Voltage H.R.C Fuse

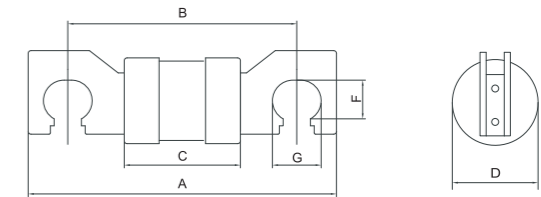

Basic Data

Model	Domesticand overseas similar products	Rated voltage (V)	Rated current (A)	Over all dimension(mm)					
				A	B	C	D	F	G
76JPU	RG8M	415/550	20~200	100	76	45	40	14	13
82JPU	RG8M	415/550	200~400	111	82	45	40	14	17
92JPY	RG8M	415/550	400~630	131	92	45	56	17	20

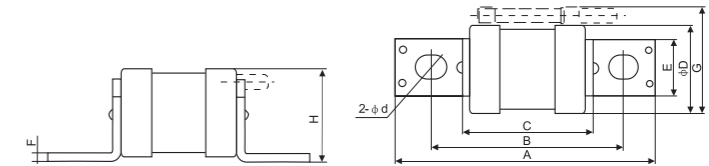

Basic Data

Model	Domesticand overseas similar products	Rated voltage (V)	Rated current (A)	Over all dimension(mm)							
				A	B	C	ΦD	E	F	H	2-Φd
RG11	RGS11	250/380	32	56	42	27.5	16.5	12.5	2	17.5	6.5x9
RG4(Z)	RGS4(Z)	660/1000	63	77	62	49.5	16.5	12.5	2	18	6.5x9
RG44(Z)	RGS44(Z)	500	100	94	72	49	32.5	25	2	21.5	11x14
RG7(Z)	RGS7(Z)	500	100	113	94	68	34	19	2	35	9x11.5

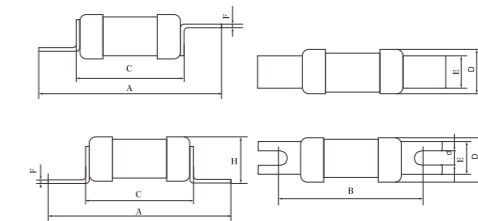

Basic Data

Model	Rated voltage (V)	Rated current (A)	Over all dimension(mm)					
			A	B	ΦD	E	F	H
F1 NS	550V80KA	2-32	59		13.5	11	0.8	
F1 NSS			64		16	14.5	1	
A1 NIT	550V80KA	2-32	55	44.5	13.5	11	0.8	14.5
A2 TIA	550V80KA	2-63	86	73	22	13	.2	24
A2 TIS	550V80KA	2-63	86	73	22	13	1.2	24
A3 TCP	550V80KA	40-100	110	94	27	19	2.0	28
A4 TFP	550V80KA	125-200	117	94	35	20	2.0	38
B1	550V80KA	2-63		111				
B1 TBC	550V80KA	2-63	137	111	22	15		
B1 TC	550V80KA	80-100						
B2 TF	550V80KA	125-200	137	111	38	18		
B3 TKF	550V80KA	-315	137	111	49	26		
B4 TKM	550V80KA	-400	137	111	56	26		